

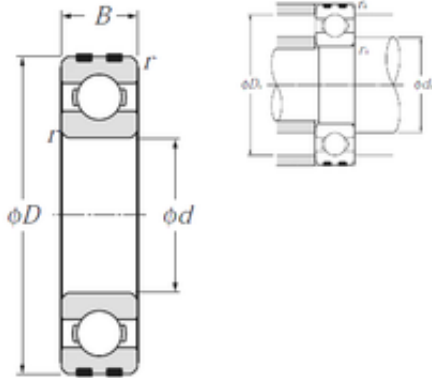

# JAPAN IMPORTED BEARINGS CO., LTD

40 mm x 90 mm x 23 mm NTN EC-6308 deep groove ball bearings



Bearing No. EC-6308

Size	40x90x23 mm
Bore Diameter	40 mm
Outer Diameter	90 mm
Width	23 mm
d	40 mm
D	90 mm
B	23 mm
C	23 mm
r min.	1,5 mm
da min.	48 mm
da max	54 mm
Da max.	82 mm
ra max.	1,5 mm
Weight	0,609 Kg
Basic dynamic load rating (C)	40,5 kN
Basic static load rating (C0)	24 kN
(Grease) Lubrication Speed	7 800 r/min
(Oil) Lubrication Speed	9 200 r/min

EC-6308 Bearing 2D drawings and 3D CAD models